

# Tsunami FP *(Filming Pig)*

## 3-10" (76-254mm)

The Tsunami FP was designed to apply inhibitor 360-degrees around the interior pipe wall. The Tsunami FP features a port holes on the front cup as well as the sides of the body. It also has a hollow core to allow the inhibitor to travel through the body.

The Tsunami FP is designed to be pliable and is typically made from 70 Shore A durometer Reliathane. It also may be launched in a pigging valve.

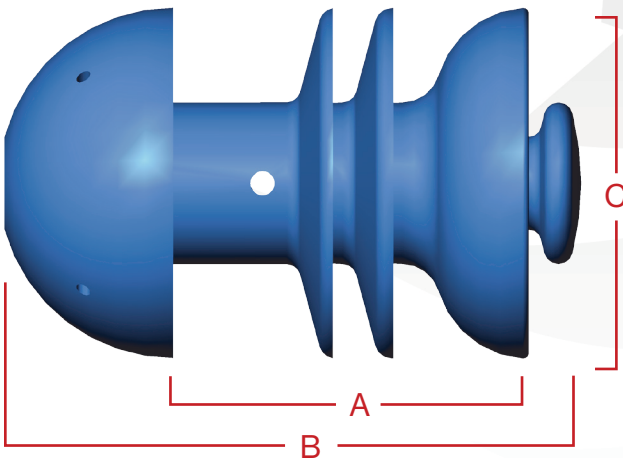

Size	A	B	C	Part #
3"	4.10	5.70	3.38	75-0472-03
4"	5.40	7.50	4.38	75-0472-04
6"	7.40	10.50	6.38	75-0472-06
8"	8.32	13.75	8.63	75-0472-08
10"	10.03	16.50	10.63	75-0472-10

Designed to negotiate 1.5D or greater bends.

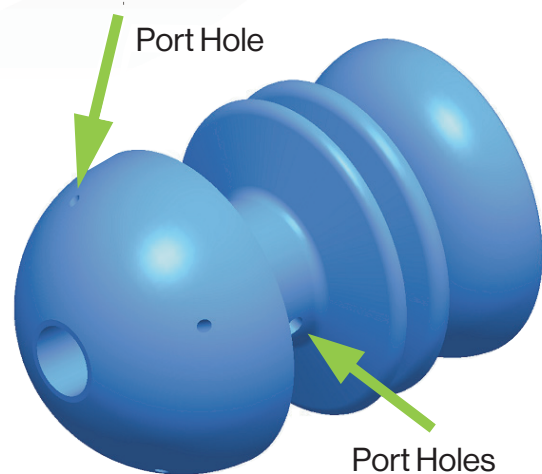

### How It Works:

Inhibitor travels through the hollow front vanity and port holes, ultimately leaving a film of protective corrosion inhibitor on the pipe wall.

### Features & Benefits:

- Lightweight - no metal components.
- Multiple seals provide excellent product interface.
- Can be utilized in Argus™, Masterflo™, and Meridian™ valves.

Check out our videos!

